

**Guidelines for Applicants for
2025 Entrance
Division of Pharmaceutical
Sciences**

**Doctoral Level Section of Integrated
Course(Three-year Course)**

(Admission for International Students)

**Graduate School of Medical Sciences,
Kanazawa University**

Application Procedures and Admission Schedule

Items	Date
Application qualification screening (for those requiring a preliminary screening)	Wednesday, November 13 - Monday, November 18, 2024
Application period	Monday, December 9 - Thursday, December 12, 2024
Print out Admission ticket	Friday, December 27, 2024 - Saturday, January 11, 2025
Examination date	Saturday, January 11, 2025
Announcement of results	Around 3 p.m., Monday, February 17, 2025
Enrollment procedures	March 2025
Entrance	April 2025

You will apply for the online application

Please refer to “How to apply and address” in the section VII” Application Procedures” on the page 6 in detail

“For applicants who are victims of natural disasters”

To reduce the financial burden on victims from natural disasters and provide the opportunity for their further their education, Kanazawa University adopts a measure to waive entrance assessment fees. Please visit the following Kanazawa University website for details, such as applicable disasters and disaster-hit areas. This target is disasters in Japan only.

Kanazawa University website>admission>Exemption and Refund of Examination Fee

https://www.kanazawa-u.ac.jp/admission/kenteiryo_henkan

If you would like to have your admission assessment fee waived, please contact Admission Division, Educational and Student Affairs Department.

Email: boshu@adm.kanazawa-u.ac.jp

The applicant is responsible for confirming all information included in the Guidelines for Applicants for his/her entrance examination category.

How to Apply [Online Application]

The application method at Kanazawa University is limited to internet applications only.
Hard copies (booklets) of the Application Guidelines for Students will not be distributed.

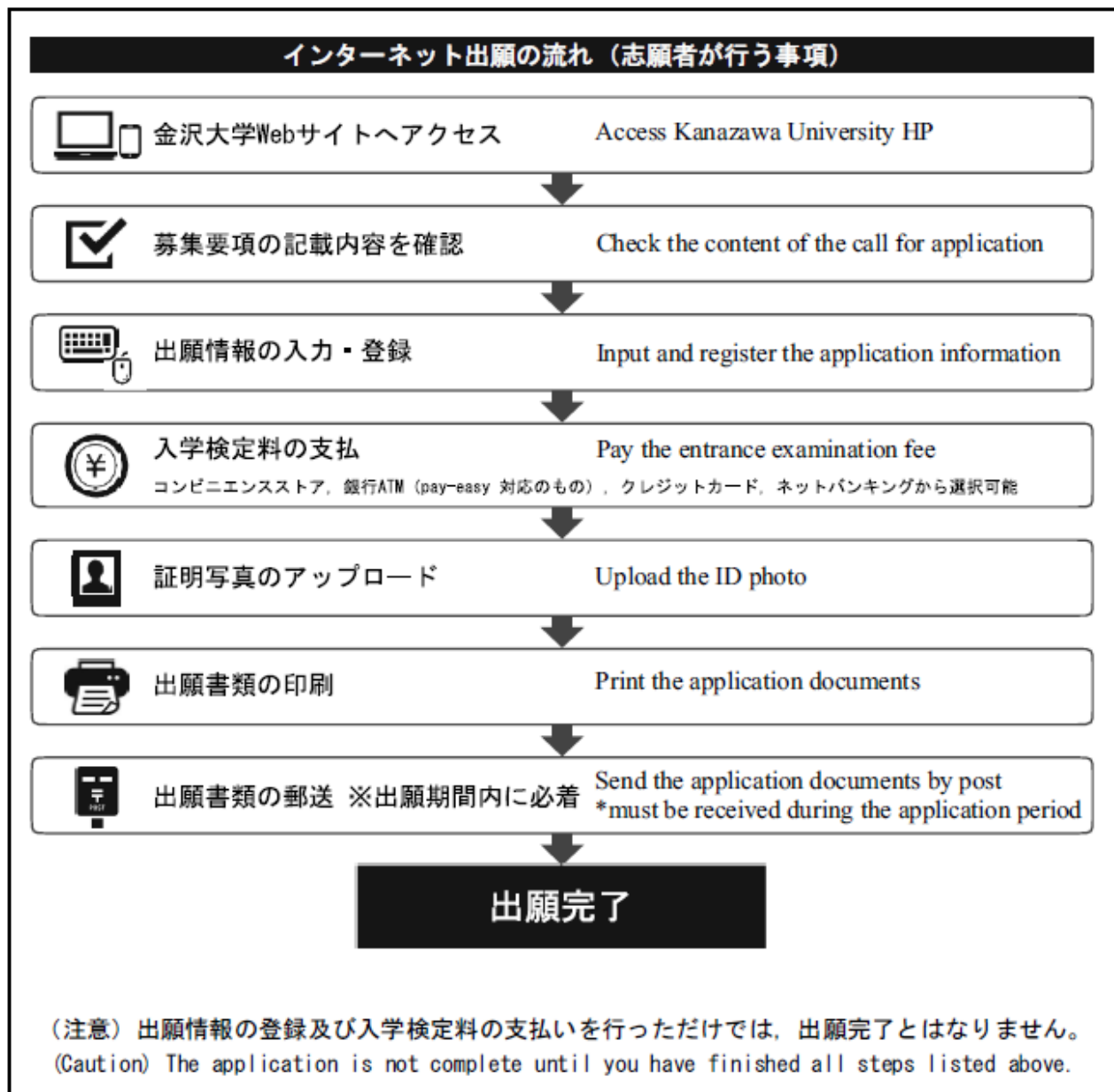

Please refer to Kanazawa University Website for the details of internet application.
Kanazawa University (Admission) Website
<https://www.kanazawa-u.ac.jp/admission>



《Internet application demonstration site》

You can experience the internet application at the demonstration site on Kanazawa University website.

https://www.kanazawa-u.ac.jp/admission/admission-information/internet_entry

**Division of Pharmaceutical Sciences
(Doctoral Level Section of Integrated Course),
Graduate School of Medical Sciences,
Kanazawa University**

I. Admission Policy

This program aims to arouse the latest knowledge and skills, as well as superior research abilities in the academic disciplines, including pharmaceutical sciences, medical and health sciences, centered on pharmaceutical sciences. Through advanced and developmental education and research approaches of the pharmaceutical sciences, the school trains independent and genuine researchers equipped with superior creativity, deep insight, great research planning abilities, strong leadership and global competitiveness. Specifically, the school cultivates human resources who play an active role as professionals engaged in the discovery, development and planning of new drugs in the pharmaceutical industry, faculty members at universities, researchers of public institutions, administrative officers in the area of medical care, public welfare, pharmaceutical affairs and environmental sciences. The Division of Pharmaceutical Sciences accepts any students regardless of previous experience in an academic discipline if they strive to succeed in these types of jobs in the future.

As basic policy on our selection of students, we consider that the followings are important:

- A higher level of academic ability (major field and English)
- High comprehension and passion to the research work
- Strong motivation to succeed in the field described above in future

In the selection process, we evaluate the basic academic ability, English proficiency, logical thinking ability, comprehension to research subject and so on.

II. Major Name and Admission Capacity

Division of Pharmaceutical Sciences : A few students

Granted degree : Doctor of Pharmaceutical Sciences or Doctor of Philosophy

III. Types of Screening

Admission for international students

IV. Application Qualification

Contact your prospective academic supervisor before submitting your application. (See the contact list at the back of the book)

All applicants must meet one of the following criteria as of March 31, 2025:

- (1) Those who with master's or professional degrees and those who are expected to obtain such a degree by March 31, 2025
- (2) Those who have been awarded a degree equivalent to a master's or professional degree in a foreign country or are expected to receive such a degree by March 31, 2025
- (3) Those who have a degree from a foreign graduate school by virtue of having completed a program at an educational institution in Japan positioned as belonging to that country's school educational system and being separately designated by the Minister of Education, Culture, Sports, Science and Technology as such or those who are expected to do so by March 31, 2025
- (4) Those who have been awarded a degree equivalent to a master's or professional degree by completing classes remotely in Japan, offered by a school abroad, or are expected to do so by March 31, 2025
- (5) Those who have completed courses at the United Nations University, which was established under the General Assembly Resolution of the United Nations on December 11, 1972, and is prescribed in Article 1 No.2 of the Act on Special Measures Incidental to Enforcement of the "Agreement between the United Nations and Japan regarding the Headquarters of the United Nations University" and have been awarded a degree equivalent to a master's degree or those who are expected to be awarded such a degree by March 31, 2025
- (6) Those who have completed an educational course at a foreign school, an educational institution designated in (3) above, or a United Nations University and have passed an examination equivalent to that provided for in Article 16-2 of the Graduate School Establishment Standards, or are expected to pass the examination by March 31, 2025, and who have been recognized as having academic ability equivalent or superior to persons who have a master's or professional degree based on individual examination of their admission qualifications by this graduate school.
- (7) Those who designated by the Minister of Education, Culture, Sports, Science and Technology.
- (8) Those who will reach 24 years of age by March 31, 2025 and have been recognized as having academic ability equivalent or superior to persons who have a master's or professional degree based on individual examination of their admission qualifications by this graduate school.

Those who are applying under the criteria of (8) and (9) must go through a preliminary screening before submitting the application. Please refer to "Preliminary Screening of Application Qualification" on Page 9.

V. Required Documents

Note on submission of the Required Document

- Please contact with preferred academic supervisor before you apply.
- Please check if all the documents are complete. The application document with insufficient may not be acceptable.
- If incorrect information is included in the application documents, the admission may be canceled.
- After accepting the application documents, the documents will not be returned, describe items will not be changed, and an entrance examination fee will not be refunded for any reasons.

(1)	Transcript	Must be issued by the president of the graduating school. *Note1,2
(2)	A certificate of (prospective) completion	Must be issued by the president of the graduating school. Those who have submitted a transcript in (2) indicating completion (or expected completion) are not required to submit the certificate. *Note1,2,3
(3)	Application checking sheet (Submission sheet)	Please print out from "Entry Completion Page" in color and A4 size after you complete the online application, and submit to us. (NOTE) You cannot print out application checking sheet if you don't complete the payment for entrance fee and uploading your ID photo. Please don't mix up with application checking sheet (confirmation sheet)
(4)	Preferred laboratory [Form1]	Please print out the form on the page 12 in A4 sized paper filled out all the blank, "Preferred laboratory · supervisor" . If you don't fill out "Second or Third Choice" in "Preferred laboratory · supervisor", we will regard you have no intension of that.
(5)	Other	International applicants who reside in Japan must submit a copy of both sides of the resident card or a copy of both sides of the alien registration card and a copy of the passport (copy of pages indicating personal information such as full name).

***Note 1: Documents written in a foreign language except English must have an attached Japanese or English translation.**

***Note 2: If documents have a different name due to a change in the family name (change of name), attach a document proving the change of name such as an extract of family register.**

***Note 3: If you apply under the criteria in application qualification, please submit the certificate of degree issued by National Institution for Academic Degrees and Quality Enhancement of Higher education.**

VI. Application Acceptance Period

**Monday, December 9 - Thursday, December 12, 2024
(JST)(Entry must arrive by the deadline date)**

Those who are applying under the criteria (8) and (9) of section IV "Application Qualification" must send an application package by 5:00 p.m. on Monday, November 18, 2024 and undergo a preliminary screening for application qualifications in advance. For more information, please refer to "Preliminary Screening of Application Qualification" on Page 9.

Ⅶ. Application Procedures

How to apply and address

Applicant will proceed with the internet application system. It is possible to access the website from the information of the entrance examination in Kanazawa University.

https://www.kanazawa-u.ac.jp/admission/admission-information/internet_entry

Please refer to the application flow concerning each step in detail.



① Register internet application contents

② Payment for the entrance examination fee

Entrance examination fee JPY 30,000

(Additional bank transfer fee is required.)

Period of payment Monday, December 2 -Thursday, December 12, 2024

Payment method Payment is available in convenience store, ATM (Pay easy), credit card (VISA, MasterCard, JCB, AMERICAN EXPRESS, Diners Club), online bank (except for PayPay bank and Seven bank)

NOTE 1. You cannot pay at bank counter.

2. You cannot pay at bank ATMs in convenience stores.

3. Name on the credit card or online bank doesn't have to be same as that of applicant.

4. After accepting the application documents, the entrance examination fee will not be refunded for any reasons. However, if you cancel the application after paying the entrance examination fee, it will be refundable. please contact with the responsible department as below by Monday, March 31, 2025. In addition, it will be not accepted after the deadline.

Please refer to the website as below about the procedure to be refunded.

<https://www.kanazawa-u.ac.jp/admission/kenteiryoenkan>

③ Upload an ID photo

Please upload a photo image of an applicant from the URL indicated in e-mail for registration confirmation after you finish registration in online application and payment for the entrance examination fee.

A digital image of an ID photo must be identified as the applicant and must be as follows.

color, upper body, unedited, uncapped, full-face, no background, taken within 3 months.

The image data size must be more than 100 KB and less than 5MB, the data format must be either JPEG or PNG.

④ Print out the application documents.

Application checking sheet (Submission sheet)	Please print out from "Entry Completion Page" in color and A4 size after you complete the online application, and submit to us. (NOTE) You cannot print out application checking sheet if you don't complete the payment for the entrance examination fee and uploading your ID photo. Please don't mix up with application checking sheet (confirmation sheet)
Address label	Please paste an address label printed in color and A4 sized on an envelope for mail after you complete the online application. (A plain paper can be printed.)

⑤ Mail required documents

Please paste an address label as ④ on a commercially available square 2 [240mm×332mm]

envelope and send application documents to Kanazawa University by registered express mail

Application materials must be sent to the following:

Pharmacy Student Affairs Section, Kanazawa University

Kakuma-machi, Kanazawa 920-1192 JAPAN Tel: (076)234-6983, 6827

<NOTICE>

Online application is not completed just by registering application information and by paying for the entrance examination fee. It is completed if you upload an ID photo and send required documents without failure by the deadline, 5:00 p.m. Thursday, December 12, 2024.

VIII. Print out Admission ticket

It will be possible to print out Admission ticket in online application system on Friday, December 27, 2024. Please log in "Application Confirmation" and print out in A4 size.

- (1) Admission ticket has URL of the website you can check the notice to take the examination and information of a place for it. Please be sure to access and check the information before taking an examination.
- (2) If you find the mistake in your name etc., please advise Pharmacy Student Affairs Section.
Contact: (076) 234-6983, 6827
- (3) Please be sure to bring printed "Admission ticket" on the day of examination.
- (4) An examination number is required for admission procedures. Please keep "Admission ticket" until then.

IX. Selection Method

Applicants are examined based on an oral exam and transcript in a comprehensive manner.

Date	Time	Examination subject	Location
Saturday, January 11, 2025	11:00~	Oral exam	Natural Science Building in Kakuma Campus (Kakuma-machi, Kanazawa-City)

X. Announcement of the Results

Around 3:00 p.m. on Monday, February 17, 2025

The results will be posted on the bulletin board at the front entrance of the Natural Science and Technology Main Hall.

In addition, you can confirm whether you have passed or not from the "online pass/fail inquiry system" on the Kanazawa University website. The notification of acceptance should be downloaded from the system (No notification will be sent). In addition, we do not respond to inquiries regarding acceptance or rejection by telephone.

Online pass/fail inquiry system

<https://www.kanazawa-u.ac.jp/admission/onlinegouhisyoukai>

XI. Enrollment Procedures and Tuitions

You will proceed by online enrollment procedure. Please refer to the "Enrollment procedures for graduate school" to be sent by the University before the middle of February.

Tuition payment, etc.

- (1) Enrollment fee: 282,000 yen (TBD)
- (2) Tuition fee (First semester): 267,900 yen (TBD)

Note: The above payment amounts are tentative. New entrance fees or tuition will apply if the entrance fee or tuition is revised at the time of enrollment or during the academic year.

XII. Miscellaneous

On the Use of Personal Information

Kanazawa University has established regulations on personal information management to properly manage and protect the information it holds.

All personal information that the University obtained during the candidate selection process and all personal information included in the documents submitted as in the enrollment process will be used for the following purposes:

- (1) Operations related to candidate selection and enrollment
- (2) Operations related to enrollment management, study instructions, and health management such as medical examinations after admission
- (3) Operations related to on-campus services such as the University's portal site, campus LAN, library, and borrowing library books after enrollment
- (4) Operations related to academic support, such as entrance-fee waivers, tuition waivers, and the selection of scholarship recipients
- (5) Operations related to the payment of entrance fees, tuition, and the operations of the financial institution to which the University outsources payment collection
- (6) Investigation and research related to candidate selection conducted in such a way that no particular individuals can be identified
- (7) Operations related to PR targeting students and their families, and related to fund (donation)
- (8) Operations related to outcome assessments for the graduates and those related to alumni relations, and the information services through Kanazawa University
- (9) Statistical work conducted in such a way that no particular individuals can be identified

Preliminary Screening of Application Qualification

Those who are applying under the criteria (8) and (9) of section IV “Application Qualification” must go through a Preliminary Screening before submitting the application.

1. Required Documents

Documents	Remarks
Application Form for Preliminary Examination of Qualifications 【Form A】	Page 13 of this guideline
Research achievement record 【Form B】	Page 14 of this guideline
Certificate of Graduation and Certificate of Enrollment Period for the last educational background	Issued by the principal of the last educational background
Certificate of Period of Employment or Certificate of Period of Research	Issued by the head of department
Application documents	The documents other than (2) and (3) of 「V. Required Documents」 on the page 5 of this guideline

(Note)

Documents written in a foreign language except for English must attach Japanese or English translation.

We may ask you to submit other additional certificates etc., if necessary.

2. Mailing Address

Please submit by mail to the address below.

Pharmacy Student Affairs Section, Kanazawa University
Kakuma-machi, Kanazawa 920-1192 JAPAN
Tel: (076)234-6983, 6827

Please mail by registered mail, and please write in red on the front of the envelope as below.
"Preliminary Screening for Application Qualifications for Graduate School of Medical Sciences,
Division of Pharmaceutical Sciences, Master's Level Section of Integrated Course"

3. Submission Period

Wednesday, November 13 – 5:00 p.m. on Monday, November 18, 2024

4. Method of Preliminary Screening and Announcement of the Results

In principle, the Screening will be conducted by examining the submitted documents. If there are unclear points in the submitted documents, or if it is difficult to review the documents, an interview may be held. If an interview is given, the applicant will be notified separately.

The results of the examination will be notified by mail to the applicant by Monday, December 9, 2024. If approved, please apply online during the application period between Monday, December 9 and Thursday, December 12, 2024, please send ② and ③ of “V. Required Document” on page 5 in this guideline.

Attachment: Research fields/teachers and research contents

◎ indicates a teacher planning to retire in March 31, 2026
 ★ indicates a teacher planning to retire in March 31, 2027

Laboratories	Research contents	Academic Supervisors
Human Molecular Genetics TEL 076-234-4487 matsukas@p.kanazawa-u.ac.jp	1. Analysis of DNA repair mechanisms using chemical biology approaches 2. Development of anticancer drugs targeting DNA damage response mechanisms 3. Mechanistic analysis of novel DNA damage induction pathways and cellular responses in quiescent cells	◎MATSUNAGA Tsukasa Professor WAKASUGI Mitsuo Associate Professor AKAHORI Ryo Assistant Professor
Vaccinology and Applied Immunology TEL 076-234-4463 shigeto@p.kanazawa-u.ac.jp	1. Development and research of the next-generation malaria vaccine with versatility 2. Development and research of bivalent vaccine effective for malaria and COVID-19 3. Study on viral-vectored vaccine-inducible innate immunity	★YOSHIDA Shigeto Professor TAMURA Takahiko Assistant Professor YAMAMOTO Yutaro Assistant Professor
Synthetic Organic chemistry TEL 076-234-4474 jimatsuo@p.kanazawa-u.ac.jp	1. Development of new organic reactions with small ring cleavage 2. Total synthesis of natural products 3. Synthesis and evaluation of bioactive molecules	MATSUO Junichi Professor HAMADA Syohei Associate Professor
Molecular Pharmacology TEL 076-234-4468 k-kaneda@p.kanazawa-u.ac.jp	1. Neural mechanisms underlying drug and behavioral addiction 2. Addictive drug-induced effects on recognition memory and sociality 3. Pathogenic mechanisms of psychiatric disorders and exploration of therapeutic drugs	KANEDA Katsuyuki Professor DEYAMA Satoshi Associate Professor NISHITANI Naoya Assistant Professor
Hygienic Chemistry TEL 076-234-4413 suzukir@p.kanazawa-u.ac.jp	1. Research on molecular and cellular mechanisms of allergic diseases 2. Study of intra- and extra-cellular factors regulating allergic inflammation 3. Research on regulation of allergic responses aimed at clinical application	SUZUKI Ryo Professor FURUKAWA Atsushi Associate Professor NAGATA Yuka Assistant Professor
Clinical and Analytical Sciences TEL 076-234-4460 kogawa@p.kanazawa-u.ac.jp	1. Development of molecular probes for cancer theranostics 2. Development of imaging probes for diagnosing various diseases 3. Development of platinum anticancer agents	OGAWA Kazuma Professor FUCHIGAMI Takeshi Associate Professor MUNEKANE Masayuki Assistant Professor
Molecular Pharmacognosy (Medicinal Plant Garden) TEL 076-234-4441 sasaki@p.kanazawa-u.ac.jp	1. Development of Japanese produced herbal medicines: methods of production and quality evaluation 2. Constituent's changes in processing and decoction process of herbal medicines and search for active components 3. Development of substitutes for Ayurvedic medicines in Japan	SASAKI Yohei Professor ANDO Hirokazu Associate Professor
Synthetic and Medicinal Element Chemistry TEL 076-234-4411 k1hirano@p.kanazawa-u.ac.jp	1. Development of novel reactions based on precise design and discovery of new reagents and catalysts 2. Synthetic main-group element chemistry towards drug discovery 3. Development of chemical transformations promoted by various external stimuli	HIRANO Keiichi Professor WANG Chao Associate Professor MATSUMOTO Akira Assistant Professor
Natural Products and Medicinal Chemistry TEL 076-234-6305 kngoto@p.kanazawa-u.ac.jp	1. Isolation and identification of bioactive natural products from rain forest plants 2. Discovery and development of drug seeds based on natural products ~ Design, synthesis, structure activity relationship, and mechanism of action study ~	NAKAGAWA-GOTO Kyoko Associate Professor SAITO Yohei Assistant Professor

Laboratories	Research contents	Academic Supervisors	
Bioorganic Chemistry TEL 076-234-4471 mishiro@p.kanazawa-u.ac.jp	1. Development of new reactions, reagents, and functionalized molecules for application in medicinal chemistry and life sciences 2. Study on a specific chemical transformation of biomolecules for elucidation of their functions 3. Creation of organic catalysts and synthetic methodology based on the characteristics of biomolecules	MISHIRO Kenji FUJITA Hikaru	Associate Professor Assistant Professor
Physical Chemistry TEL 076-234-4425 fukuyosi@p.kanazawa-u.ac.jp	1. Computational study of protein structure	FUKUYOSHI Shuichi	Associate Professor
Uchiyama Research Group TEL 076-234-4428 uchiyama@p.kanazawa-u.ac.jp	1. Development of environmentally benign synthetic reactions 2. Research related to the synthesis of bioactive natural products	UCHIYAMA Masahiko	Associate Professor
Collaborative Research Group with the Institute of Nature and Environmental Technology TEL 076-234-4455 n_tang@staff.kanazawa-u.ac.jp	1. Behavioral analysis of environmental pollutants 2. Evaluation of health effects of environmental pollutants	TANG Ning	Professor
Molecular Pharmacotherapeutics TEL 076-234-4465 ykato@p.kanazawa-u.ac.jp	1. Optimization of drug therapy based on physiologically based pharmacokinetic modeling 2. Molecular discrimination between nutrients and foreign compounds by membrane transporters and their regulatory mechanisms 3. Disposition and neurogenesis promoting effects of food-derived compounds	KATO Yukio MASUO Yusuke ISHIMOTO Takahiro	Professor Associate Professor Assistant Professor
Drug Metabolism and Toxicology TEL 076-234-4408 nmiki@p.kanazawa-u.ac.jp	1. Research on drug metabolism to promote drug development and appropriate use of medicine 2. Research on post-transcriptional regulation mechanisms of drug-metabolizing enzymes 3. Research on mechanisms of drug toxicity to predict and prevent adverse drug reactions	NAKAJIMA Miki FUKAMI Tatsuki	Professor Associate Professor
Drug Delivery and Science TEL 076-234-4479 tnakam@p.kanazawa-u.ac.jp	1. Characteristic and kinetic analysis of gastrointestinal physiology to quantitatively predict oral drug absorption and interaction 2. Quantitative analysis of food/beverage effects on gastrointestinal physiology and drug absorption 3. Mechanistic analysis of drug-induced gastrointestinal toxicity involving gut hormone and microbiota	NAKAMURA Takashi SHIRASAKA Yoshiyuki	Professor Associate Professor
Clinical Pharmacy and Healthcare Sciences TEL 076-234-4467 (Arakawa) arakawa@p.kanazawa-u.ac.jp TEL 076-264-6286 (Yoshida) naoko.p@p.kanazawa-u.ac.jp	1. Elucidation of novel mechanisms for pharmacokinetics and drug-induced toxicity 2. Research related to promote the appropriate medicines distribution and against substandard and falsified medicines: investigating the situation and formulating countermeasures	ARAKAWA Hiroshi YOSHIDA Naoko	Associate Professor Associate Professor
Host Defense and Responses TEL 076-234-4481 tkuraishi@p.kanazawa-u.ac.jp	1. Study on host-microbe interactions 2. Study on sterile inflammation	KURAISHI Takayuki HORI Aki	Associate Professor Assistant Professor

受験番号 Identification Number	※
-------------------------------	---

令和7年度

【様式1】
【Form1】

金沢大学大学院医薬保健学総合研究科創薬科学専攻（博士後期課程）

Division of Pharmaceutical Sciences (Doctoral Level Section of Integrated Course), Graduate School of Medical Sciences, Kanazawa University

志望研究室等

《氏名》 Full Name

《志望研究室》 Preferred laboratory

	志望研究室名 Name of laboratory of your choice	志望指導教員の署名 Signature of preferred academic supervisor
第1志望 First Choice	研究室	
第2志望 Second Choice	研究室	

注) 出願前に志望指導教員に連絡を取り、出願の許可を得てください。

10, 11ページを参照の上、志望する研究室を記入し、志望指導教員の署名を得てください。遠方等の理由により署名を得ることが難しい場合は、志望指導教員の承認を示すメールの写しの提出で代用可とします。第2志望の記載がない場合は、その意志がないものとみなします。

NOTE) Please contact with preferred academic supervisor and get permission before you apply.

Please refer to page 10,11 to fill out Name of laboratory of your choice and ask preferred academic supervisor to signature. If it is difficult to get signature of preferred academic supervisor, a copy of the e-mail indicating approval of preferred academic supervisor is accepted. If you don't fill out "Second Choice", we will regard you have no intension of that.

《口述試験使用機器》 Device needed for oral exam

口述試験使用機器 Device needed for oral exam	プロジェクター Projector	:	必要 / 不要 necessary / unnecessary
---	----------------------	---	------------------------------------

注) 口述試験におけるプロジェクターの使用希望について、該当する方を○で囲んでください。

その他の機器使用を希望する場合は、薬学学務係へ問い合わせてください。

NOTE) Please circle necessary or unnecessary to use projector for oral exam.

Please ask Pharmacy Student Affairs Section if you need another device.

《長期履修希望》 longer-term program

長期履修希望 Apply for the longer-term program

注) 長期履修を希望する場合は✓を記入してください。

NOTE) Mark the box with a ✓ if you are applying for the longer-term program.

《博士論文研究基礎力審査 (QE) の申請 (学内進学者のみ) 》

Applying for Qualifying Examination (Only students from Graduate School of Medical Sciences)

有り Applied 無し Not applied

注) 博士論文研究基礎力審査 (QE) の申請状況について✓を記入してください。

NOTE) Fill in the application status of Qualifying Examination.

【様式A】
【Form A】

入学試験出願資格認定申請書

Application Form for Preliminary Examination of Qualifications

受験番号 Identification Number	※	金沢大学大学院医薬保健学総合研究科創薬科学専攻(博士後期課程) Division of Pharmaceutical Sciences (Doctoral Level Section of Integrated Course), Graduate School of Medical Sciences, Kanazawa University			
金沢大学大学院医薬保健学総合研究科長 殿 To: Dean of Graduate School of Medical Sciences, Kanazawa University					
<p>貴大学大学院医薬保健学総合研究科創薬科学専攻（博士後期課程）入学試験に出願を希望します。 ついては、出願資格の認定を受けたいので、所定の書類を添えて申請します。</p> <p>I hereby wish to apply for the preliminary screening of qualifications to take an entrance examination for the Division of Pharmaceutical Sciences (Doctoral Level Section of Integrated Course), Graduate School of Medical Sciences at Kanazawa University. I have attached prescribed documents to apply for the screening.</p>					
令和 Date:		年 Year	月 Month	日 Day	
			氏名 Full name	Signature	男・女 Male /
Female					
(歳)	年		月	日生	
		Date of Birth:	Year	Month	Day Age
現住所 Current address		〒 Tel() -			
現職 Current employment:	勤務先 Place of employment				
	職名 Job title				
	所在地 Address		Tel() -		
学歴（高等学校卒業から詳細に記入願います。） Educational background (List your education in detail after graduating from a high school)					
年 Year	月 Month	日 Day	Graduated from		高等学校卒業 High school
年 Year	月 Month	日 Day			
年 Year	月 Month	日 Day			
年 Year	月 Month	日 Day			
年 Year	月 Month	日 Day			
年 Year	月 Month	日 Day			
年 Year	月 Month	日 Day			
職歴（研究・開発の業務内容が分かるように詳細に記入願います。） Employment history (List your employment history in detail indicating the details of research and development)					
年 Year	月 Month	日 Day			
年 Year	月 Month	日 Day			
年 Year	月 Month	日 Day			
年 Year	月 Month	日 Day			
学会その他における活動状況 Activity status at academic conferences, etc.					
年 Year	月 Month	日 Day			
年 Year	月 Month	日 Day			
年 Year	月 Month	日 Day			

注) 本様式に書き切れない場合は、同様の形式のものを付加してください。
Note) Attach additional paper in a similar format if additional space is needed.

キャンパスマップ

金沢大学所在地略図

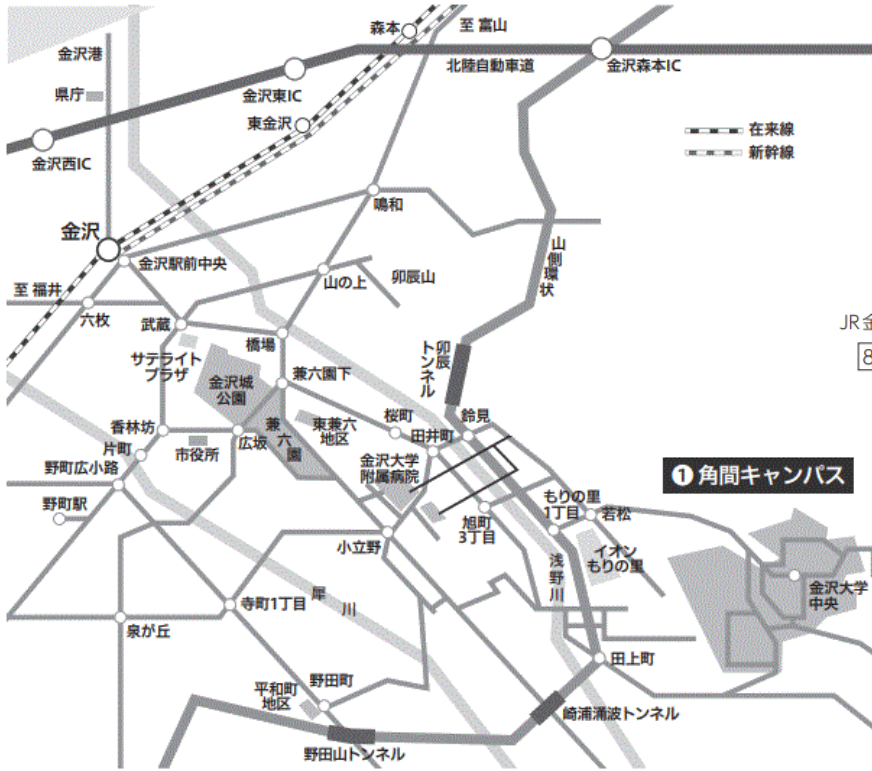

① 拡大図

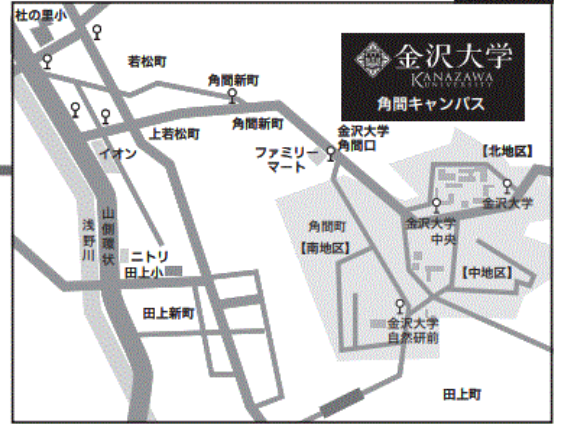

JR 金沢駅兼六園口 (東口) バスターミナルから北陸鉄道バス

8番乗り場発

乗車：93, 94, 97 金沢大学行き

下車：金沢大学自然研前

(JR 金沢駅から約 35 分)

① 角間キャンパス

北陸鉄道
Web サイト



キャンパスマップ
Web サイト



角間キャンパス

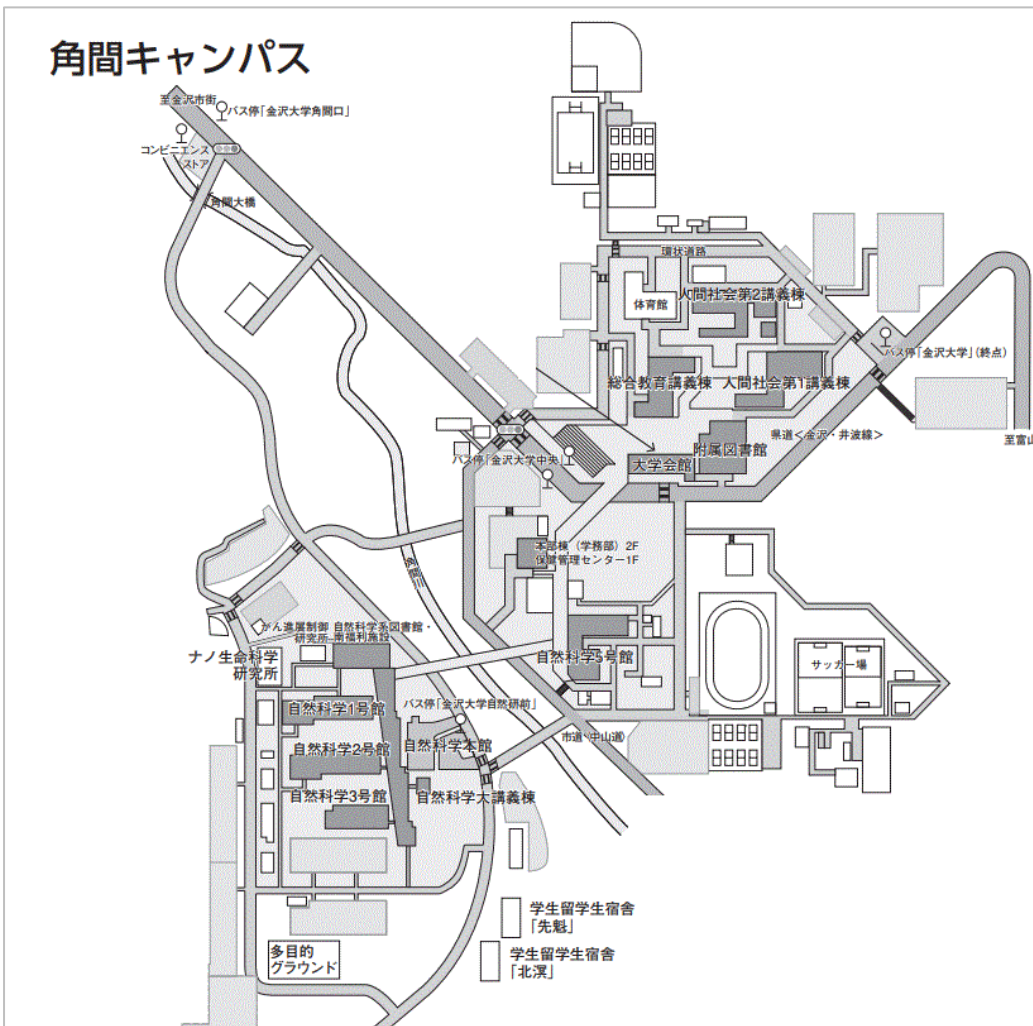

問い合わせ先

金沢大学薬学学務係

〒920-1192 金沢市角間町

TEL (076) 234-6983, 6827

FAX (076) 234-6844

Kanazawa University Strategic Project for Development of Doctoral Students and Research Promotion (HaKaSe⁺)

HaKaSe⁺

Kanazawa University is reinforcing support for aspiring students of the Doctoral Level Section of Integrated Course / Doctoral Course, thus fostering and nurturing research personnel with a doctoral degree who will be the seed of advancement of Science and Technology and innovation in Japan and around the world, and be responsible for creating a future society. In this "Kanazawa University Strategic Project for Development of Doctoral Students and Research Promotion (HaKaSe⁺)", KU provides various support such as enhancement for concentration on research, development of interdisciplinarity and internationality, career development after obtaining a doctoral degree in addition to financial support.

The following projects are supported by Japanese government as part of the support for doctoral students for the advancement of science and technology and creation of innovation in Japan. Thus, content of supports may be subject to change due to the end of the project or system changes.

【Projects for fostering and nurturing doctoral talents with Grant-type scholarship (Apply to FY2024)】

M, Master's Level Section of Integrated Course / Master's Course; D, Doctoral Level Section of Integrated Course; MD, 4-year Doctoral Course

			WISE Program for Nano-Precision Medicine, Science, and Technology (HaKaSe ⁺ for WISE)	SPRING Project for Doctoral Talents in Creating Novel Values (HaKaSe ⁺ for SPRING)	BOOST Project for Trailblazing AI Crossover Doctoral Talents (HaKaSe ⁺ for BOOST)
Content of project			Degree course	Support for research and career formation	Promoting cultivation of doctoral talents and cutting-edge research and development in both AI field and emerging/integrated areas in AI field (Next-generation AI field)
Target for Support			Natural Science and Technology, M&D; Medical Sciences, M&D/MD; Advanced Preventive Medical Sciences, MD; Frontier Science Initiative, M&D	All Divisions with Doctoral Level Section of Integrated Course / Doctoral Courses	All Divisions with Doctoral Level Section of Integrated Course / Doctoral Courses
Capacity			12/fiscal year	Varies depending on the fiscal year [In total, around 160 for the fiscal year]	2/fiscal year
Support period (in principle)			For 5 years consisting of 2 years of Master's Level Section of Integrated Course / Master's course and 3 years of Doctoral Level Section of Integrated Course, or for 4 years of 4-year Doctoral Course; within standard period of courses	Within standard period of Doctoral Level Section of Integrated Course or of 4-year Doctoral Course	Within standard period of Doctoral Level Section of Integrated Course or of 4-year Doctoral Course
Contents of financial support	Master's Level Section of Integrated Course / Master's Course	Grant for living expenses per month	50,000 yen (in principle)		
		RA salary	ca. 360,000 yen per year maximum		
	Doctoral Level Section of Integrated Course / Doctoral Course	Grant for living expenses per month	180,000 yen (in principle)	180,000 yen	250,000 yen
		Research fund per year	400,000 yen	400,000 yen	900,000 yen
		RA salary	ca. 240,000 yen per year maximum (Only for those in the first year of 4-year Doctoral Course)	—	—
	Support for travel expenses, etc.		Support unique to the project available	Support unique to the project available	Support unique to the project available
	Exemption of Admission fee		Full exemption	—	—
	Exemption of Tuition fee		Full exemption	Half exemption	Half exemption
Restrictions			<p>[Students of the Doctoral Level Section of Integrated Course / Doctoral Course who fulfill any of the following conditions cannot receive the grant for living expenses]</p> <ul style="list-style-type: none"> Those who receive research incentives from the Research Fellowship for Young Scientists (DC) of the Japan Society for the Promotion of Science (JSPS); International students receiving support from the Japanese Government (MEXT) Scholarships; Those who receive a scholarship from the Japan Student Services Organization (JASSO); International students who receive the JASSO Honors scholarship; International students receiving support such as a scholarship from their home countries; Those who receive a Kanazawa University scholarship, etc. (mainly for the purpose of support for living expenses); Working part-time (with some exceptions such as TA and RA). 	<p>[Those who fall under any of the following conditions cannot apply]</p> <ul style="list-style-type: none"> Those who receive research incentives from the Research Fellowship for Young Scientists (DC) of the Japan Society for the Promotion of Science (JSPS); International students receiving support from the Japanese Government (MEXT) Scholarships; International students receiving support such as a scholarship from their home countries; Those who receive a Kanazawa University scholarship, etc. (mainly for the purpose of support for living expenses); <p>[Adult students who fall under one of the following conditions cannot apply]</p> <ul style="list-style-type: none"> Those who earn stable income such as a salary and executive compensation at a sufficient level (2.4 million yen/year) as living expenses from the university or company to which they belong; Those who do not receive a sufficient amount of living expenses (based on 2.4 million yen/year) even though there is a system that allows them to receive such an allowance from the company, etc., to which they belong. <p>Apart from the above income requirements, those who are judged by HaKaSe⁺ to be unable to fulfill the obligation to devote themselves to research as a selected student, or not to be in a situation where they can devote themselves to the career development and nurturing content by HaKaSe⁺ are not qualified.</p> <p>[International students]</p> <p>International students must pledge that they are to be employed at a Japanese company, university, research entity, etc. (including overseas subsidiary) or an internationally affiliated company in Japan for 3 years or more after completing Kanazawa University Graduate School.</p>	

[Inquires for HaKaSe⁺] Educational and Student Affairs Division, Educational and Student Affairs Department, Kanazawa University jisedai@adm.kanazawa-u.ac.jp

Please check HaKaSe⁺ Website for the latest information.

<https://phd.w3.kanazawa-u.ac.jp/en/>